

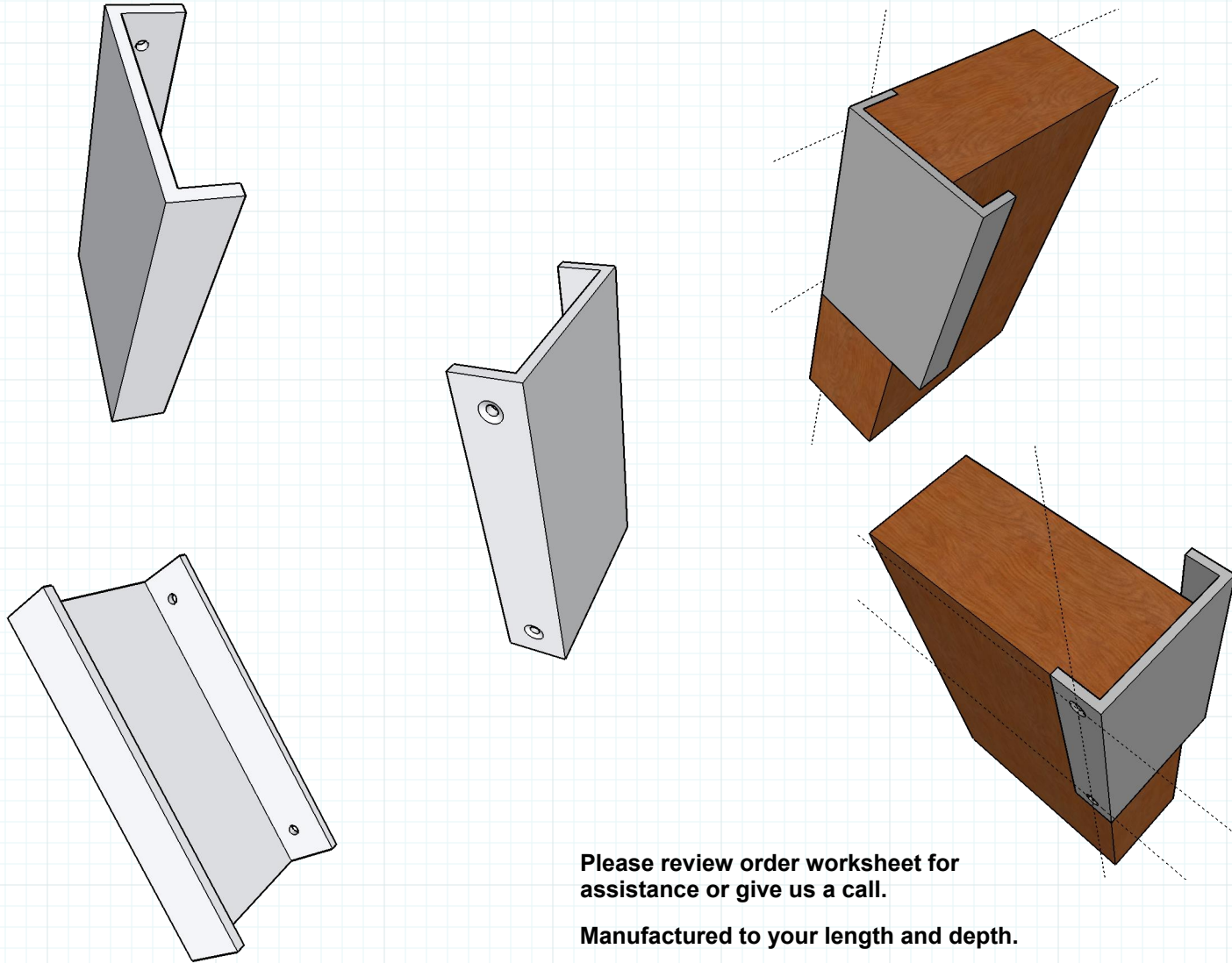

# RJ729 Angle Pull w/ Rear Return Edge Pull

#RAJACK #RJ729



## Finishes

- US03 Pol. Brass
- US03A Pol. Brass N/L
- US04 Satin Brass
- US04A Satin Brass N/L
- US05 Antique Brass
- US09 Polished Bronze
- US10 Satin Bronze
- US10A Dark Bronze
- US10B Oil Rubbed Bronze
- US14 Pol. Nickel
- US14A Pol. Nickel N/L
- US15 Satin Nickel
- US15A Satin Nickel N/L
- US19 Satin Black
- US26 Pol. Chrome
- US26D Satin Chrome

**Powder Coating All RAL Colors**

## Match Your Sample

\* RAJACK can match any custom or existing hardware finishes provided you submit a sample when placing order.

Please review order worksheet for assistance or give us a call.

Manufactured to your length and depth.

Material Thickness 1/8"

Screws: #6 3/4" Philips Flat

729-01

RAJACK.com

[rajackhardware](https://www.instagram.com/rajackhardware)  
*Follow us on Instagram*

[info@rajack.com](mailto:info@rajack.com)

**RAJACK HARDWARE**  
95 Rome Street  
Farmingdale, NY 11735  
631-293-8273 Phone



# RJ729 Angle Pull w/ Rear Return

## Edge Pull

#RAJACK #RJ729

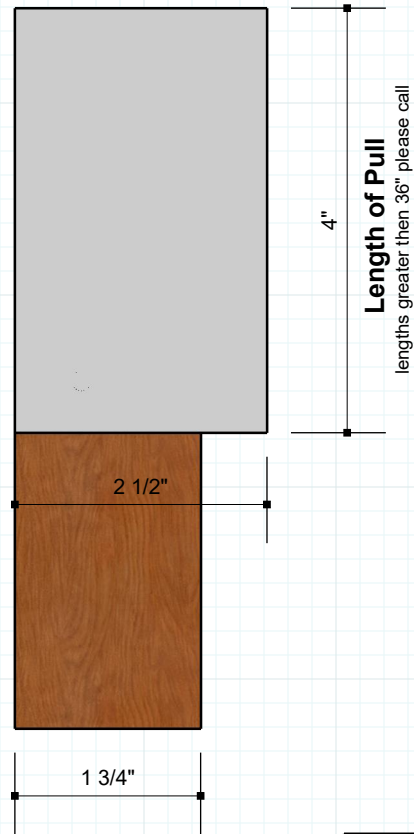
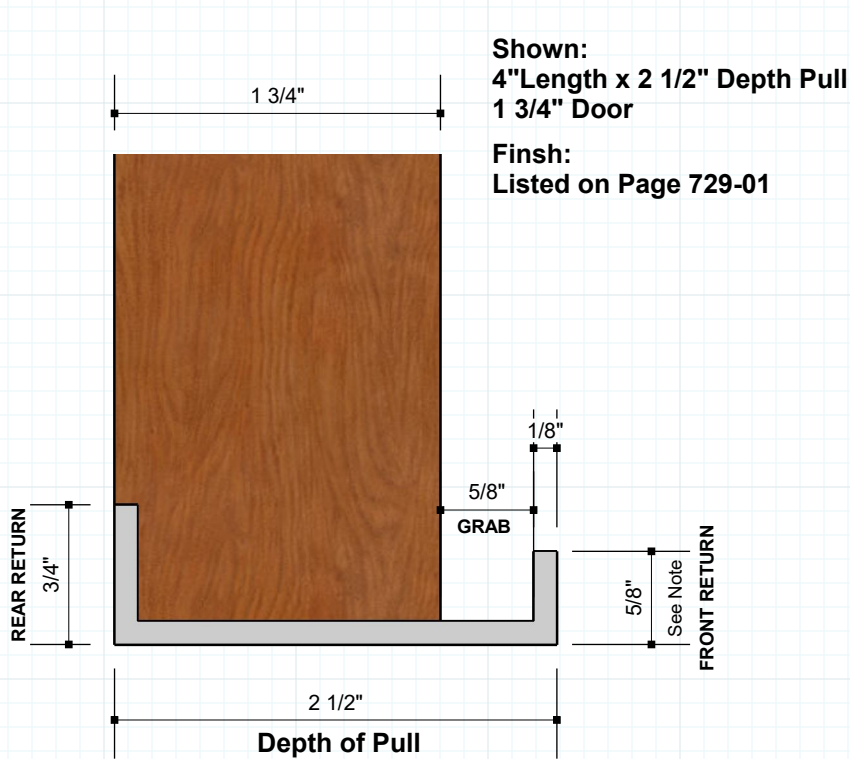

Manufactured to your length and Depth  
**Material Thickness 1/8"**  
**Screw: #6 3/4" Philips Flat**

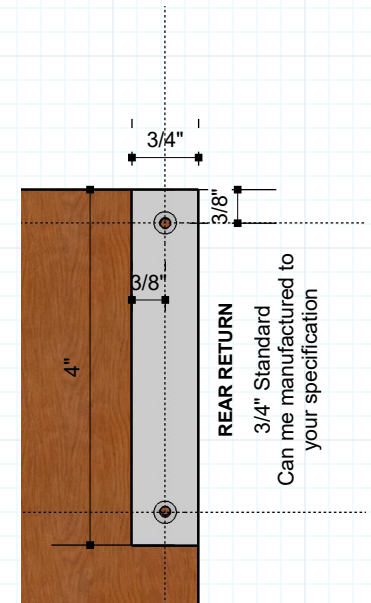

**Length of Pull** are manufactured based on your request. Any length within reason can be made. If greater than 24" please call to discuss with RAJACK.

**Standard Depths of Pull** are manufactured on the halves for this pull. Available depth sizes 1 1/2" , 2" , 2 1/2" , 3"

**Custom Depths of Pull** can be manufactured. Call to discuss additional cost and lead time.

1/2" or more **GRAB** area behind front return is suggested and assumed unless otherwise specified.

5/8" **FRONT Return** standard for pull depth 2" or greater. Pulls that have a depth of less than 2" have a standard return of 1/2"

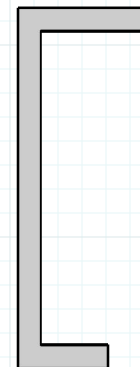

729-02

**RAJACK.com**

 **rajackhardware**  
Follow us on Instagram

**info@rajack.com**

**RAJACK HARDWARE**

95 Rome Street  
Farmingdale, NY 11735  
631-293-8273 Phone



# RJ729 Angle Pull w/ Rear Return

## Edge Pull

#RAJACK #RJ729

### Quote/Order Scratch Sheet

See previous pages for additional information

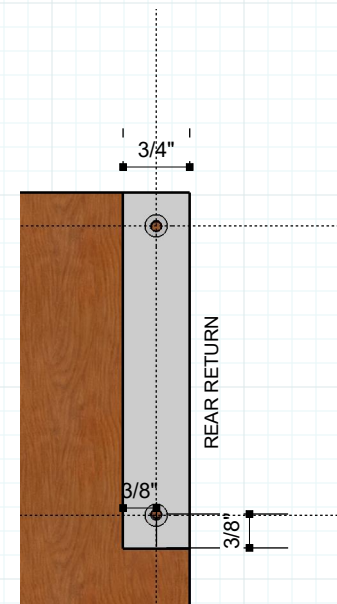
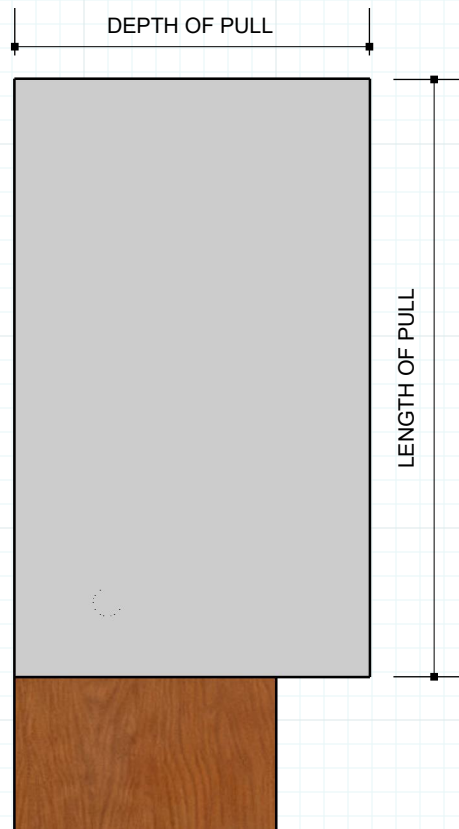
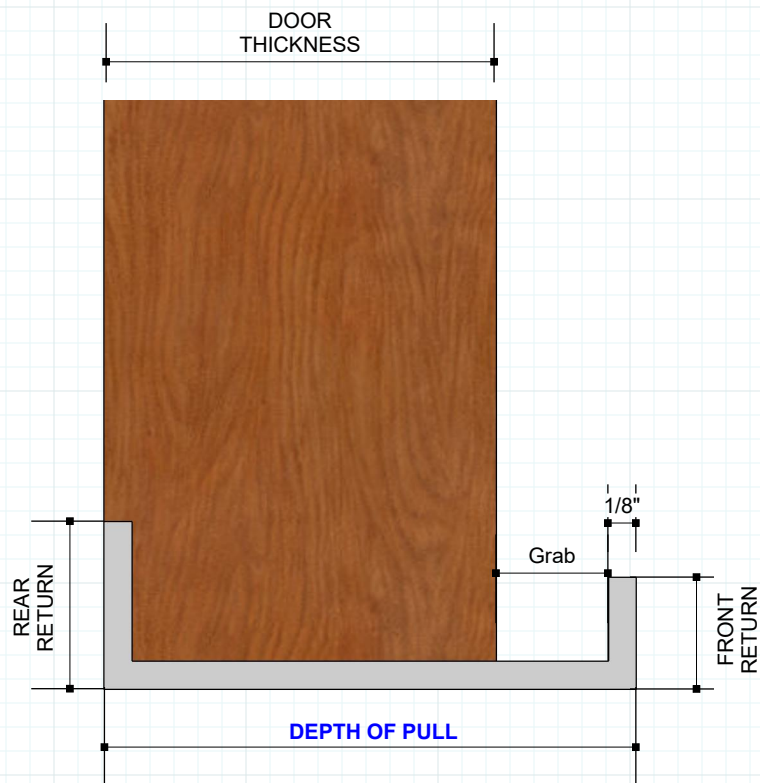

Material Thickness 1/8"  
 Screws: #6 3/4" Philips Flat  
 Made to Order

729-03

**RAJACK.com**

 **rajackhardware**  
*Follow us on Instagram*

**info@rajack.com**

**RAJACK HARDWARE**  
 95 Rome Street  
 Farmingdale, NY 11735  
 631-293-8273 Phone